

Reticle Catalogue

Digital Day&Night Vision Scope&Clip-On

CHEETAH Series

Scope: C32F-S | C32F-SN | C32F-SL | C32F-SNL

Clip-On: C32F-R | C32F-RN | C32F-RL | C32F-RNL



Reticle 1

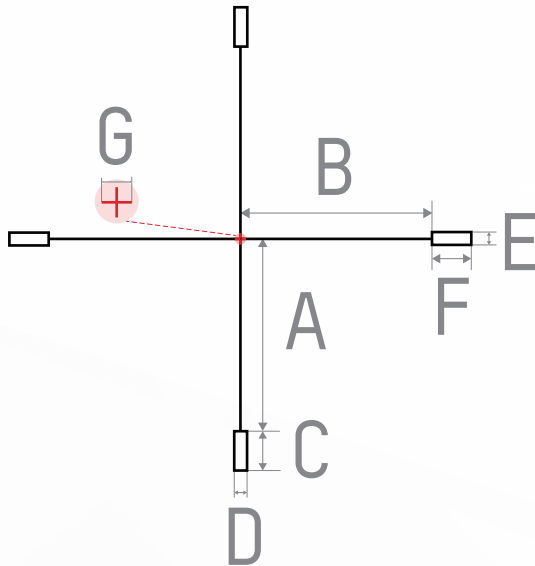

Reticle parameters (for 1x magnification)	MOA	cm@100m
Section A	78.8	229.3
Section B	78.8	229.3
Section C	15.9	46.3
Section D	4.8	14.0
Section E	4.8	14.0
Section F	15.9	46.3
Section G	5.2	15.1

Reticle 2

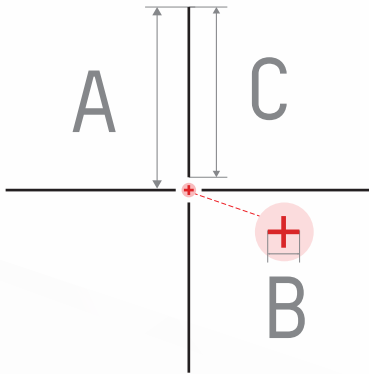

Reticle parameters (for 1x magnification)	MOA	cm@100m
Section A	94.4	274.6
Section B	5.2	15.1
Section C	88.1	256.2

Reticle 3

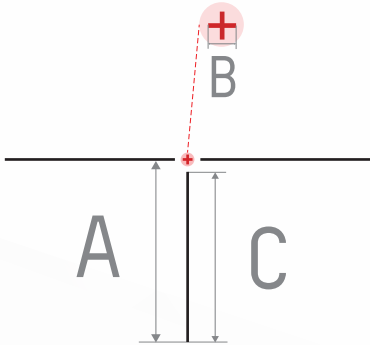

Reticle parameters (for 1x magnification)	MOA	cm@100m
Section A	94.4	274.6
Section B	5.2	15.1
Section C	88.5	257.3

Reticle 4

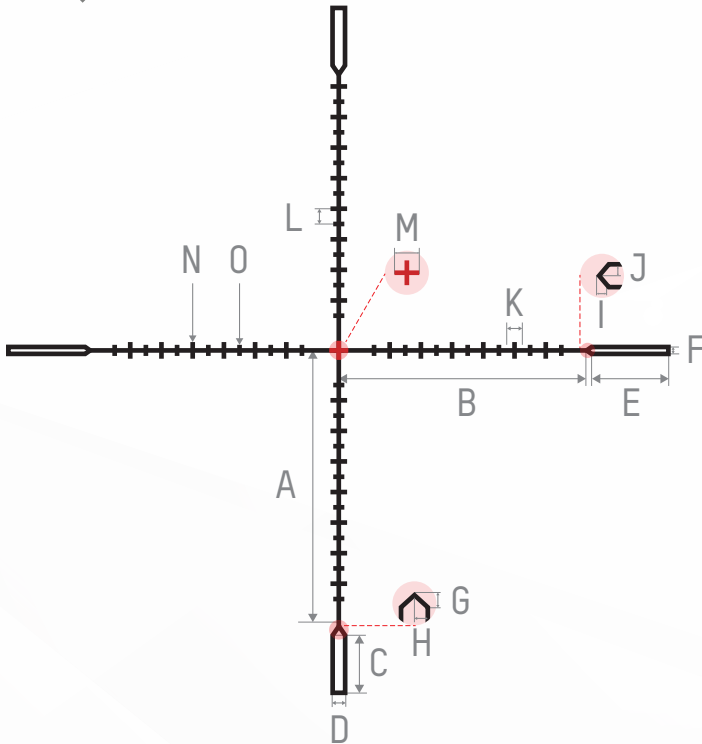

Reticle parameters (for 1x magnification)	MOA	cm@100m
Section A	73.7	214.3
Section B	67.0	194.9
Section C	15.9	46.3
Section D	3.3	9.7
Section E	20.7	60.3
Section F	1.9	5.4
Section G	1.9	5.4
Section H	1.9	5.4
Section I	1.1	3.2
Section J	1.1	3.2
Section K	3.3	9.7
Section L	3.3	9.7
Section M	5.2	15.1
Section N	4.4	12.9
Section O	3.0	8.6

Reticle 5

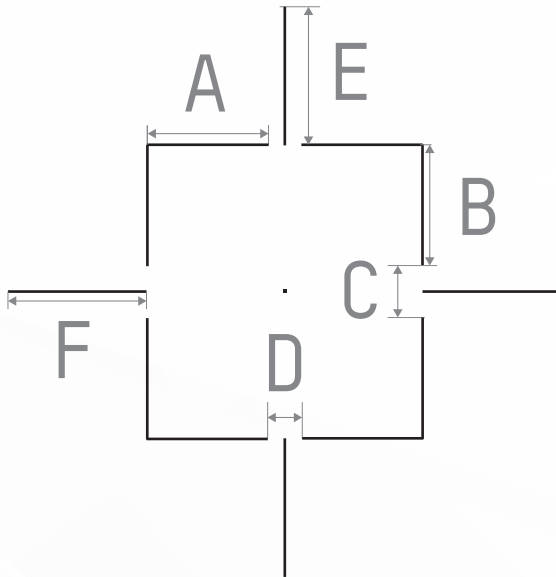

Reticle parameters (for 1x magnification)	MOA	cm@100m
Section A	2.6	7.5
Section B	2.6	7.5
Section C	1.1	3.2
Section D	0.7	2.2
Section E	3.0	8.6
Section F	3.0	8.6

Reticle 6

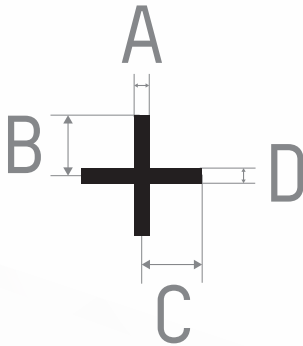

Reticle parameters (for 1x magnification)	MOA	cm@100m
Section A	1.1	3.2
Section B	4.4	12.9
Section C	4.4	12.9
Section D	1.1	3.2

Reticle 7

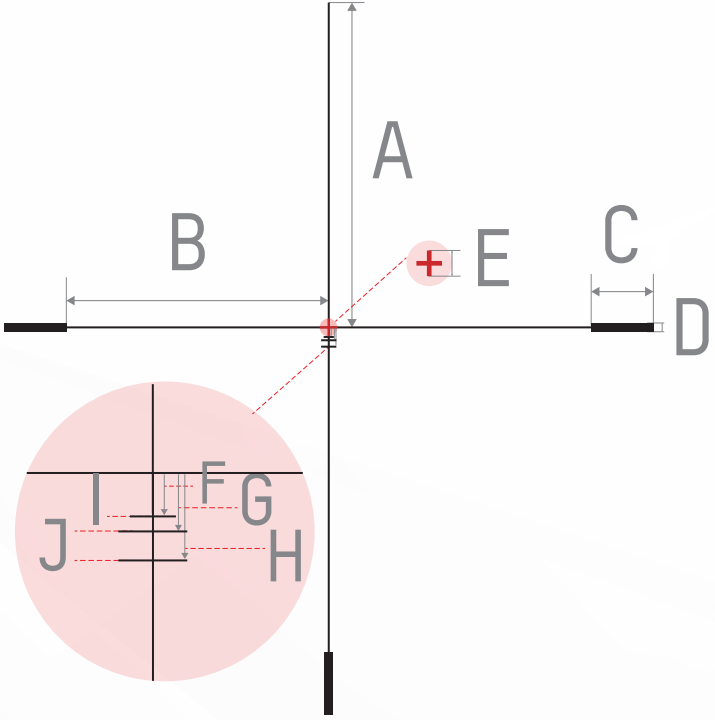

Reticle parameters (for 1x magnification)	MOA	cm@100m
Section A	94.8	275.6
Section B	76.6	222.9
Section C	18.1	52.8
Section D	2.6	7.5
Section E	5.2	15.1
Section F	3.7	10.8
Section G	5.6	16.2
Section H	8.1	23.7
Section I	3.0	8.6
Section J	4.4	12.9

Reticle 8

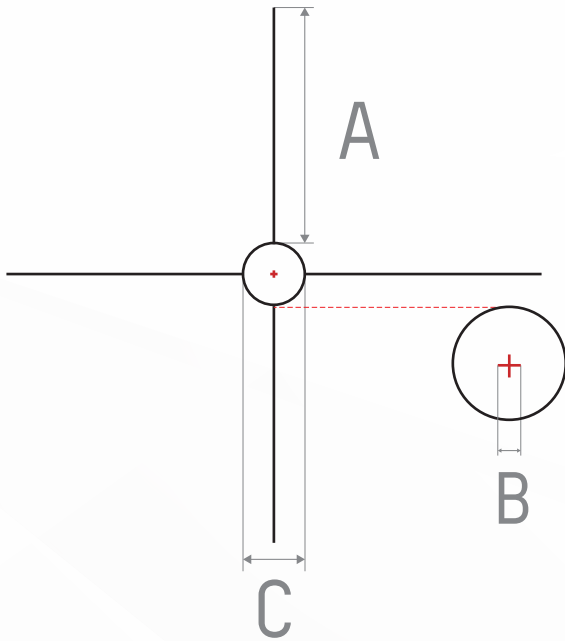

Reticle parameters (for 1x magnification)	MOA	cm@100m
Section A	83.6	243.3
Section B	4.8	14.0
Section C	21.8	63.5

Reticle 9

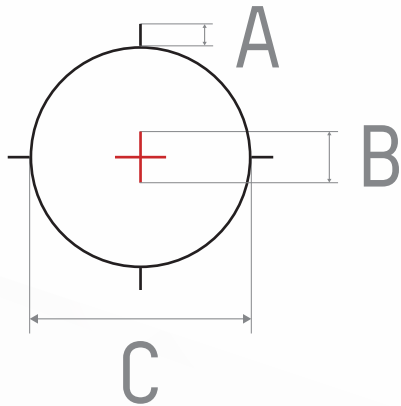

Reticle parameters (for 1x magnification)	MOA	cm@100m
Section A	2.2	6.5
Section B	4.8	14.0
Section C	22.2	64.6

Reticle 10



Reticle parameters (for 1x magnification)	MOA	cm@100m
Section A	4.1	11.8

